



鸿力机械

HongLi Machinery

中国·江门

鸿力机械

专业生产定制

各种液压升降平台

→ 液压升降机平台 专业生产商

江门市鸿力机械有限公司

JIANGMENCITY HONGLI MACHINERY CO., LTD

地址：广东省江门市杜阮镇上岗中心路9号4幢

电话:0750-3830248 传真:0750-3689848

网址:www.jmhljx.com

邮箱:763588728@qq.com

江门市鸿力机械有限公司

JIANGMENCITY HONGLI MACHINERY CO., LTD

公司简介

COMPANY EXHIBITION



江门市鸿力机械有限公司,专业生产制造销售:液压升降平台、家用电梯、升降货梯、登车桥、卸货调节板、铝合金升降机、车载升降机、升降舞台、旋转舞台、汽车尾板等液压物流设备。公司拥有一批技术精湛、经验丰富、专业从事本行业20年以上的高级机械工程师、及专业工程技术人员组成的团队和一流的售后服务,完善的专业设计,品质保证,值得您信赖!我们将始终恪守“客户至上”的原则,为客户提供更及时、更专业、更高品质的服务。我们的诚信、实力和产品质量获得业界的认可。可根据客户

尺寸上门量身定制专属您的设计方案!

以优良的品牌,完善的服务,本着“节能环保、经济实用”为宗旨,不断精益求精,为广大国内外客户提供工艺先进,性能稳定的产品,为国家能源、环保作出重大贡献。

Jiangmencity Hongli Machinery Co., Ltd specializes in the production, manufacturing, and sales of hydraulic lifting platforms, cargo elevators, boarding bridges, cargo platform adjustment plates, aluminum alloy elevators, car elevators, lifting stages, rotating stages, car tailboards, and other hydraulic logistics equipment. The company has a team of highly skilled, experienced senior mechanical engineers and professional engineering technicians who have been engaged in this industry for more than 20 years, as well as first-class after-sales service, complete professional design, quality assurance, and is worthy of your trust! We will always adhere to the principle of "customer first" and provide customers with more timely, professional, and high-quality services. Our integrity, strength, and product quality have been recognized by the industry. You can customize your exclusive design plan according to the customer's size on site! With excellent brand, perfect service and the purpose of "energy conservation, environmental protection, economy and practicality", we will continue to strive for perfection, provide customers at home and abroad with products with advanced technology and stable performance, and make significant contributions to national energy and environmental protection.

公司展示 COMPANY EXHIBITION

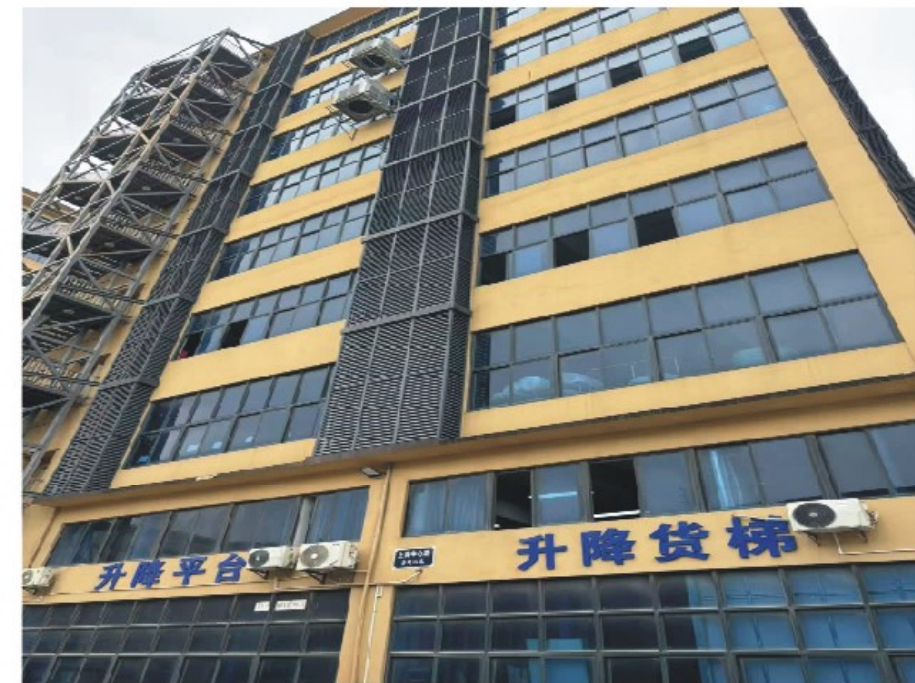

车间展示 WORKSHOP DISPLAY



油缸制作区域



剪叉制作区域



油缸摆放区域

车间展示 WORKSHOP DISPLAY



钢材开料区域

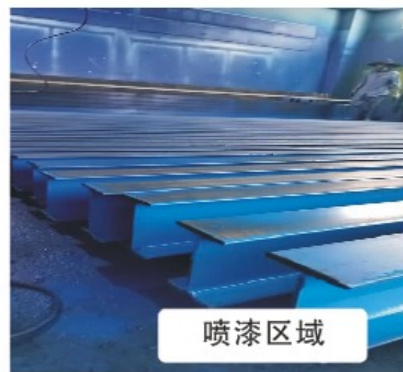

喷漆区域



半成品暂放区域

液压升降平台 HYDRAULIC LIFTING PLATFORM

液压升降平台是一种轨道垂直向立体升降平台,由于最低高度50-100mm,最适用于不能开挖地坑和井道楼层开口较小的工业场所,同时无需上部吊点。产品主要用于二层、多层工业厂房、餐厅、酒楼楼层间的货物运输。

有单柱、双柱、三柱、四柱等多种形式、动作平稳,操作简单可靠,是目前取代电动葫芦简易吊笼最理想的液压升降货梯设备,造价是电梯的五分之一,工作效率接近电梯的80%,更是节约首选的新型节能设备。

起升高度:1米~30米;

载重:0.2T-30T;

台面、内容大小高低可根据客户需求定做各种非标产品。

The hydraulic lifting platform is a vertical rail-oriented three-dimensional lifting platform. Due to the minimum height of 50-100mm, it is most suitable for industrial sites where pits and wells with small openings cannot be excavated, and there is no need for upper lifting points. The products are mainly used for cargo transportation between floors of two-story and multi-story industrial plants, restaurants and restaurants.

There are single-column, double-column, three-column, four-column and other forms. Stable action, simple and reliable operation, is currently the most ideal hydraulic lifting freight elevator equipment to replace the electric hoists simple hanging cage, the cost is one-fifth of the elevator, the work efficiency is close to 80% of the elevator, and it is a new type of energy-saving equipment that is the first choice for saving.

Lifting height: 1m~30m;

Load: 0.2T~30T;

The size of the countertop and content can be customized according to customer needs for various non-standard products.



产品结构 PRODUCT STRUCTURE

液压升降平台主要由三部分组成，分别为：**机械系统、液压系统和电气系统。**
The hydraulic lifting platform is mainly composed of three parts: mechanical system, hydraulic system and electrical system.

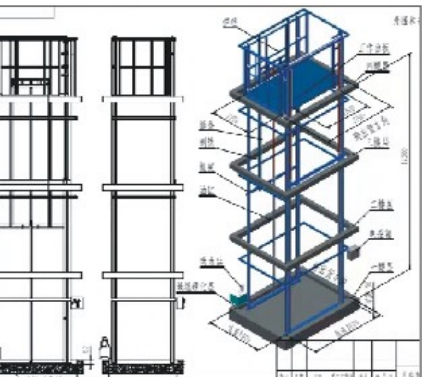

机械系统分为四部分:机架、轿厢平台、升降机构、安全防护部件(门、护栏等)。

The mechanical system is divided into four parts: frame, car platform, lifting mechanism, and safety protection components (doors, guardrails, etc.).

液压系统分为液压泵站总成(动力元件、控制元件、辅助元件、液压油)、液压油缸(执行元件)。由电动机驱动液压泵泵油，经过辅助液压元件(电磁阀、油路)推动液压执行元件(油缸)，进而带动轿厢平台上下行。

The hydraulic system is divided into a hydraulic pump station assembly (power component, control component, auxiliary component, hydraulic oil), and a hydraulic cylinder (execution component). The hydraulic pump is driven by an electric motor pump oil, which passes through auxiliary hydraulic components (solenoid valves, oil pipes) and pushes the hydraulic actuator (oil cylinder), thereby driving the car platform up and down.



电气系统用以控制电机的启动、电磁阀的开闭，从而达到轿厢平台上、下行的目的。除主电源外所有控制线路均采用36V以下的安全电压控制。

The electrical system is used to control the start of the motor and the opening and closing of the solenoid valve, so as to achieve the purpose of going up and down the car platform.



安装案例展示 INSTALLATION CASE SHOW

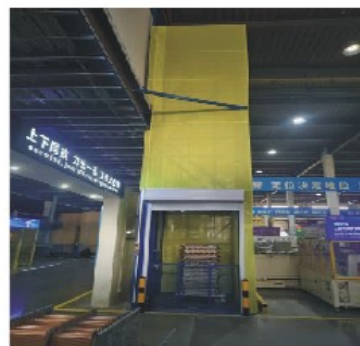

井道安装案例

HOISTWAY INSTALLATION CASE



室内靠阁楼 / INDOOR ATTIC



室外安装现场图 / OUTDOOR INSTALLATION SITE DIAGRAM



家用别墅电梯

HOUSEHOLD VILLA ELEVATOR



家用别墅电梯是一种新型的家庭定制载人电梯，此电梯是由液压油缸传动轿厢实现各楼层反复升降的一款小型电梯。此款电梯具有无机房，占地面积小，可在复杂的环境中安装。不管是城市别墅，还是农村自家房都可以报装。

多用于生产流水线高度差之间货物运送，物料上下线，工作装配时调节工作高度，高处给料机送料，大型设备装配时部件举升，仓储装卸场所与叉车等搬运车辆配套进行货物快速装卸等。

The home villa elevator is a new type of customized family passenger elevator, which is a small elevator that is driven by hydraulic cylinders to repeatedly lift and lower each floor. This elevator has no machine room, occupies a small area, and can be installed in complex environments. Both urban villas and rural self-owned houses can be reported for installation.

It is mainly used for transporting goods between height differences in production lines, loading and unloading materials, adjusting the working height during work assembly, feeding materials to load machines at high altitudes, lifting components during large equipment assembly, and supporting storage and loading sites with forklift and other transport vehicles for rapid loading and unloading of goods.



剪叉升降平台

SCISSOR FORK LIFTING PLATFORM

剪叉升降平台：直接从地面起升装卸，无需另外设置货台、钢架、专业设计的活动搭板与货车车厢平滑搭接，叉车、手动搬运车都能快捷、平稳地进行装卸作业；作业完毕后平台与地面相平，不占据地面空间，不影响通道通行。

多用于生产流水线高度差之间货物运送，物料上下线，工作装配时调节工作高度，高处给料机送料，大型设备装配时部件举升，仓储装卸场所与叉车等搬运车辆配套进行货物快速装卸等。

Scissor lift platform: lift loading and unloading directly from the ground, no need to set up additional cargo platform, steel frame, professionally designed movable deck can be smoothly overlapped with the truck compartment, forklifts and manual trucks can be quickly and smoothly loaded and unloaded; After the operation is completed, the platform is level with the ground, does not occupy the ground space, and does not affect the passage of the passage.

It is mostly used for the transportation of goods between the height difference of the production line, the loading and unloading of materials, the adjustment of the working height during the work assembly, the feeding of the loading machine at a high place, the lifting of parts during the assembly of large equipment, the storage and loading and unloading places and forklifts and other transport vehicles for last loading and unloading of goods, etc.



餐厅传菜电梯

RESTAURANT SERVICE ELEVATOR



传菜电梯是指用于宾馆、厨房、食堂、饭店、幼儿园、商厦、工厂等部门，用于传送食品、餐具、日用品的电梯。传菜电梯一般分为落地式和窗口式，可提供快捷、方便、经济的小型货物运输，为用户大大节省了时间及人力资源。

The vegetable elevator refers to an elevator used in hotels, kitchens, canteens, restaurants, kindergartens, commercial buildings, factories, and other departments to transport food, tableware, and daily necessities. The vegetable elevator is generally divided into floor type and window type, which can provide fast, convenient, and economical transportation of small goods, saving users a lot of time and human resources.



移动式登车桥

MOBILE BOARDING BRIDGE

升降车库 | LIFT GARAGE

移动式液压登车桥是与叉车配合使用的货物装卸辅助设备，可根据汽车车厢的高低调节高度，叉车可以直接通过本设备驶入车厢内部进行货物的批量装卸，仅需单人作业，即可实现货物的快速装卸。它使企业减少大量劳动力，提高工作效率，获取更大经济效益。

The mobile hydraulic pallet truck is a cargo loading and unloading auxiliary equipment used in conjunction with a forklift. The height can be adjusted according to the height of the car compartment. The forklift can directly drive into the compartment through this equipment for batch loading and unloading of goods, which can be realized by only one person. Fast loading and unloading of goods. It enables enterprises to reduce a lot of labor, improve work efficiency, and obtain greater economic benefits.

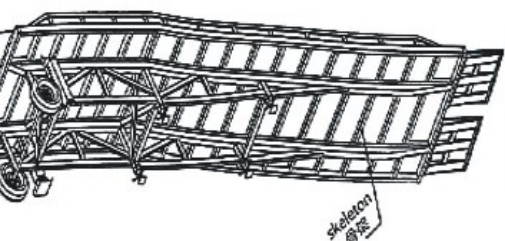
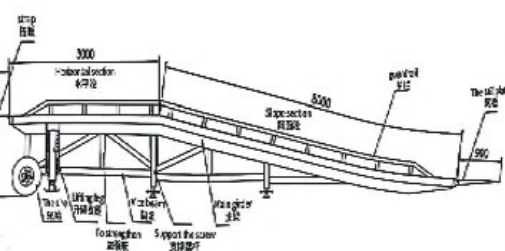

固定式调节板

FIXED ADJUSTMENT PLATE

高度液压调节板又名：固定式登车桥和月台平台。固定式液压调节板是用于快速装卸货物的特殊辅助设备。其高度调节功能可在卡车和仓库的货物平台之间建立桥梁。叉车和其他搬运车辆可以通过调节板直接驶入卡车，以进行批量上货/下货。

适用场合：仓库、车站、码头、仓储物流基地、邮政运输、物流配送等。

Hydraulic height adjustment plate also known as: fixed boarding bridge and platform. The fixed hydraulic adjustment plate is a special auxiliary equipment for fast loading and unloading of goods. Its height adjustment function creates a bridge between the truck and the warehouse's cargo platform. Forklifts and other handling vehicles can be driven directly into the truck through the adjustment plate for bulk loading/unloading.

Applicable occasions: warehouse, station, wharf, warehousing and logistics base, postal transportation, logistics and distribution, etc.



移动式装卸平台

MOBILE LOADING PLATFORM

液压系统分为液压泵站总成(动力元件、控制元件、辅助元件、液压油)、液压油缸(执行元件)。由电机驱动液压泵泵油,经过辅助液压元件(电磁阀、油管),推动液压执行元件(油缸),进而带动台面上、下行。

The hydraulic system is divided into hydraulic pump station assembly (power element, control element, auxiliary element, hydraulic oil) and hydraulic cylinder (actuating element). The hydraulic pump is driven by the motor to pump oil, and through the auxiliary hydraulic components (solenoid valve, oil pipe), the hydraulic actuator (cylinder) is pushed, and then the table is driven up and down for batch loading and unloading of goods, which can be realized by only one person. Fast loading and unloading of goods. It enables enterprises to reduce a lot of labor, improve work efficiency, and obtain greater economic benefits.



重点安全配置说明



链条防松(断)检测
当平台运行中出现链条松弛或断链现象,可立即检测到故障并传递给PLC,PLC瞬时切断电源,报警灯闪烁,平台停止工作



称重检测/超载保护报警
当拉力传感器检测到货物超出额定载重时,报警灯闪烁,升降平台不能启动



失压/缺相/错相/冲顶保护
当出现以上问题,自动切断电源或自动切断载货平台的上升动力源



防坠保护装置
防止载货平台失去支持力加速下降或坠落的抱死装置



停层保护装置
转层平台时,机械臂伸出,能够保证装卸货物时台面不出现下沉和反弹现象,并能保障操作人员装卸货物时的安全,并配置电气联锁



油管防爆
防止液压缸因管路破裂、泄漏而导致载货平台失控下降



智能门锁
门锁装置应由重力保持锁紧,锁紧时禁止元件的嵌入深度不应少于7mm,且具备检测功能



轿厢配重门
配重门与门控有电气联锁,当配重门落下关好后,轿厢才能正常通电运行



安全光幕
在机器运行或停止状态下,如有异物遮挡光线,机器会自动停止。



行程开关
用于安全门上,门不关好机器无法启动。

